

**INDIAN INSTITUTE OF ENGINEERING SCIENCE AND TECHNOLOGY
SHIBPUR, P.O. Botanic Garden
(Formerly Bengal Engineering and Science University)
HOWRAH (West Bengal, India)-711103.**

ADVT No. REBECA 2016/02

Date:-18.03.2016

Sealed quotations are invited from bonafide Contractors/ Event Production Houses, for the whole work as specified below under the name of **Production of REBECA2016, 78th Annual Reunion and Cultural Fest of IEST,Shibpur** to be held on 31st March-3rd April,2016.Sealed quotation should be dropped in the drop box at the Office of the Dean, Infrastructure Planning and Management between 11.00 a.m. to 1.30 p.m.by 25.03.2016.Opening of the bid will be on 25.03.2016 at 3.30 p.m.

Convener
REBECA 2016
IEST,Shibpur

Copy To: 1.To be displayed on the Institute Website

*Indian Institute of Engineering Science and Technology, Shibpur
Howrah-711103*

Name of Tender: Production of REBECA 2016, Annual Reunion and Cultural Fest of IEST, Shibpur.

1. Name of the Firm :
(Inblock letter)
2. Office Address :
3. Phone No. :
4. Whether Partnership / Proprietorship Firm:
5. Name of Partner(s) / Proprietor(s) :
6. PAN No. :
7. Trade License No. :
8. Sales TaxNo. :
9. Quoted rate (for the whole work):
(Use separate sheet, if required)

Bill of quantities for the production: Sound equipment, Light equipment, LED Displays, Generator power, Stage Design, Venue Cover (to be considered as a whole and indivisible work).

SOUND EQUIPMENT REQUIREMENTS

Sl.	Item	Preferred Model	Quantity
1	Line Array Speaker System	DAS Aero 50 / JBL VerTec 4888 / Similar	16
2	1600 Watt Sub Speaker Box	JBL 728S / JBL VerTec 4882 Sub / Similar	12
3	Side Fill Speaker on Stage	JBL 725/ JBL JRX series	4
4	Side Fill Sub Speaker on Stage	JBL 718S/SB 1000	4
5	Drum Fill	LA 115 /JBL PRX series	2
6	Drum Fill Sub	JBL 718S / JBL PRX series	2
7	Centre Fill	JBL VRX	8
8	Centre Fill Horn loaded Sub	QW 218 / similar	6
9	Floor Wedges for Vocal	JBL 915M / JBL PRX active / Wedge LA	4
10	Floor Wedges for Band	OQS K12/ JBL PRX active / Wedge LA	8
11	Lead Guitar Amps	Marshall JCM 900/1000/ similar	1
12	Bass Guitar Amps	Hartke HA5500 /LH1000 /similar	1
13	Keyboard Amps	Roland KC 550/880	1
14	In-ear Monitor System	Sennheiser IEM 300	8
15	Cordless Microphone	Sennheiser Evolution 500 series E945	5
16	Corded Microphone	Sennheiser E945	10
17	"	Shure SM 58	10
18	"	Shure SM 57	10
19	"	Shure SM 81	4
20	"	Shure Beta 52A	1
21	"	Sennheiser Evolution 900 series (Drum Kit)	1
22	"	AKG Rhythm Pack (Drum Kit)	1
23	"	Sennheiser E906 Guitar Amps	2
24	"	Audix D6	1
25	"	AKG C1000	2
26	"	Shure Beta 91A	1
27	Cordless Guitar System	Shure PG1 for Lead Guitar	3
28	FOH Sound Console	AVID Venue SC48	1
29	CD Player	Pioneer 2000 Nexus	2
30	DSP Processor	XTA DP448	1
31	DI Box	BSS or Radial	as per requirement
32	Microphone and Stage gear Stands - Iron Base Stainless Steel		as per requirement
33	Amplifier		as per requirement
34	Double Top with Subs	JBL 725 and JBL 718S	6 each

NOTE:

1. The stage backline equipments have been specified based on moderate tech riders of general Bollywood artistes. Hence, for items 11, 12 and 13 specifically and for other microphone systems and sound gears, the models required may moderately vary according to artiste's tech-rider and if required, the variations need to be adjusted and provided in place of the mentioned model within quoted rates. For this replacement of models, artiste's tech-riders shall be provided in advance.
2. For item 28: In case the artiste's tech-rider requires a 48 channel Analogue mixer, it needs to be accommodated as per requirement.

LIGHT SPECIFICATION

Sl.	Item	Quantity
1	Sharpy Beam	30
2	LED Par	60
3	Par 64	12
4	Par 61	12
5	Laser Beam	1
6	Blinder Spot	8
7	Profile	4
8	Long Follow	1
9	Smoke	2
10	Haze	1
11	Fire Machine	4
12	Avolite Pearl 2014	2
13	Power Pack	12
14	Splitter	10

NOTE:

The vendor may provide more quantities of the abovementioned sound and light items (if it does not affect the quoted rates in any way) and in such case the promised quantities are to be mentioned.

LED DISPLAY SPECIFICATION:

1. 8ft by 12ft Main Center Display
2. 4 Nos. Display Wing 10ft by 3ft
3. Mixing Console
4. Video Jockey

GENERATOR POWER:

1. 125 kV Soundproof Genset. (And back up if needed)
2. 60 kV Soundproof Genset. (And backup if needed)

STAGE DESIGN:

1. Main Stage: Dimension: 40ft x 40ft
2. LED Riser: 4 ft high and 14 ft wide
3. Drum Riser: 8ft x 8ft
4. Four (4) Sided Metal Box Truss supported on truss posts of 20ft height with central truss beam to support a small circular truss suspended downwards from it.
5. Sound, Light, Video and LED Console Setup
6. 200ft Metal Barricade
7. Metal Stairs both at rear and front of stage
8. 8ft x 12ft Ramp with Cage
9. Black masking and stage carpet (blue/red) and minor stage decorations.

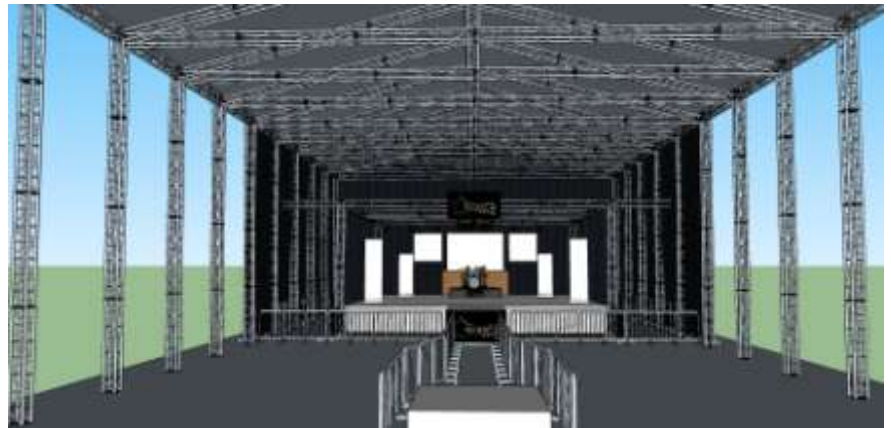
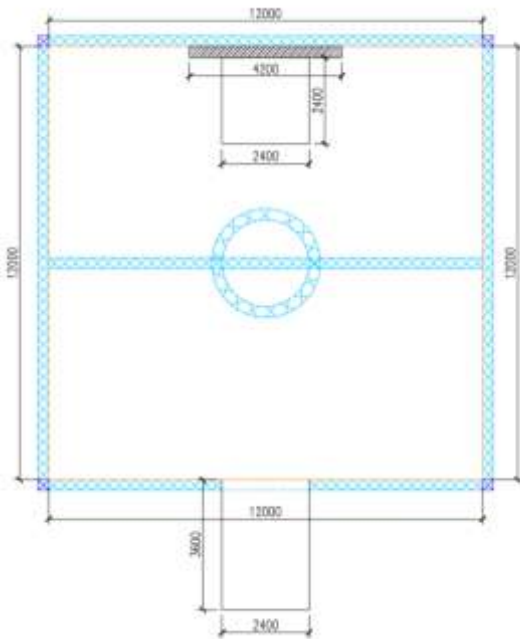

VENUE COVER:

1. Hangar / Truss Structure as per design (triangular section) and specifications provided for stage area and audience.
Length: 120 ft. Span: 60ft (span must be adjusted to accommodate 20ft high stage truss)
-

To
The Convener, REBECA 2016
IEST,Shibpur
Howrah-711103

I/WE agree to execute the work in accordance to requirement at the above quoted items rates for a total price of Rs. _____ (Rupees)

Authorized Signature: _____ Dated:- Address:-

Name & Title of Signatory:

Name of the bidder and Seal:

Terms & Conditions:-

1. All rates quoted should be inclusive of all taxes, levies & duties. The rates should be quoted both in figures and words. Request for inclusion of any tax/levy at later stage will not be entertained.
2. Transportation, Packing, Forwarding and Insurance Charges (if any) to be charged should be specifically indicated.
3. The Institute reserves the right to accept or reject all or any of the tenders without assigning any reason whatsoever. The decision of the Institute shall be final in case of any dispute.
4. **The installation work must be completed by 8.00a.m. on 31st March 2016. Dismantle the Installation after 8.00 a.m. of 4th April 2016.**
7. Materials & accessories used should be as per specification and of Approved Quality (B.I.S.).
8. Bills in Triplicate should be presented for payment within 15 days of completion of work.
9. The Order no. is to be noted on both the Challan and the Bill.
10. All bills are to be accompanied by order copies and challans as received.
11. Payment will be made within 60 days of Submission of proper bills, challans etc.
12. Last date of submission of quotation is **24.03.2016 up to 1.30 p.m. at the Office of the Dean, Infrastructure Planning and Management (Convener, REBECA 2016, IEST, Shibpur).**
13. **Opening on 24.03.2016 at 3.30 pm at the office Dean, Infrastructure Planning and Management (Convener, REBECA 2016, IEST, Shibpur).**
14. For any query contact Mr. Soham Karmakar (9007566336) or Mr. Soumik Acharyya (8902772030), Secretary, Stage and Decorations, REBECA 2016, IEST Shibpur.

Convener
REBECA 2016
IEST,Shibpur