



Dated: 07-09-2018

**Sub: Invitation for Quotation**

Sealed Quotations are invited from Manufacturers, suppliers and agents to carry out the following works as mentioned below:

**Item No.-1:** a) Fabrication of water channel for recirculation of the water for the Tilting Flume at Hydraulics & Fluid Mechanics Laboratory made of 1<sup>st</sup> class Brick, 1:4 Cement Sand Morter, 1:4 Cement Sand plaster on both side, complete with neat cement finish.

**Dimension:** 14'L × 2'W × 20"H

b) P.P.C Flooring inside the water channel made of 1:2:4 concrete (2" thick), complete with 1:4 Cement Sand Plaster on the top surface of floor and neat cement finish.

**Dimension:** 14'L × 2'W × 2"thick

c) "V-Notch" comprised with water channel made of 6 mm thick M.S. Plate, 40 mm×40 mm MS Angle, Complete with 2 coats of anticorrosive Bituminous paint.

**Dimension:** 2'W × 20"H

2) a) Water supply line from the existing over head 6" dia pipe line to Tilting Flume, made of 6" × 3" dia GI reducer, 3" dia GI short piece, 3" dia UPVC FTA, 3" dia PVC Elbow, 3" dia PVC Gate valve and 3" dia × 14' L UPVC pipe.

b) 3' L UPVC pipe holder, made of 40 mm × 40 mm M.S. Angle, complete with proper welding and 2 coats of anti corrosive Bituminous paint

3) Proper repairing the 4" dia suction pipe line with 7'L × 4" dia × 3 mm thick M.S. pipe, 4" dia M.S. Socket, 4" dia × 3" L GI short piece, complete with proper welding and 2 coats of anti corrosive Bituminous paint.

4) Supplying, fitting and fixing the 4" dia CI Gate valve (ISI standard)

5) S.S. Baffle made of S.S. Net along with 2" W proper S.S. binding with 304 Grade S.S. Sheet

Size: 2' × 1 $\frac{1}{2}$ ' (6 mm Mesh) ----- 1 No.

2' × 1 $\frac{1}{2}$ ' (12 mm Mesh)----- 1 No.

6) Wooden batten made of 2'L × 2" W × 1 $\frac{1}{2}$ " thick 1<sup>st</sup> class Teak wood section.

Sealed Quotation should be submitted to:

Head of the Department of Aerospace Engineering & Applied Mechanics  
Indian Institute of Engineering Science & Technology, Shibpur  
Howrah- 711103, West Bengal

Last Date of submission: 19<sup>th</sup> September 2018 (Wednesday) upto 2.00 pm

Date of Opening: 20<sup>th</sup> September 2018, (Thursday) at 3-00 pm

(Dr. Koustuv Debnath)

Head of the Department of Aerospace Engineering & Applied Mechanics  
Indian Institute of Engineering Science & Technology, Shibpur  
Howrah- 711103, West Bengal

Copy to: 1. Notice Board of A.E. & A.M.

2. Institute Website

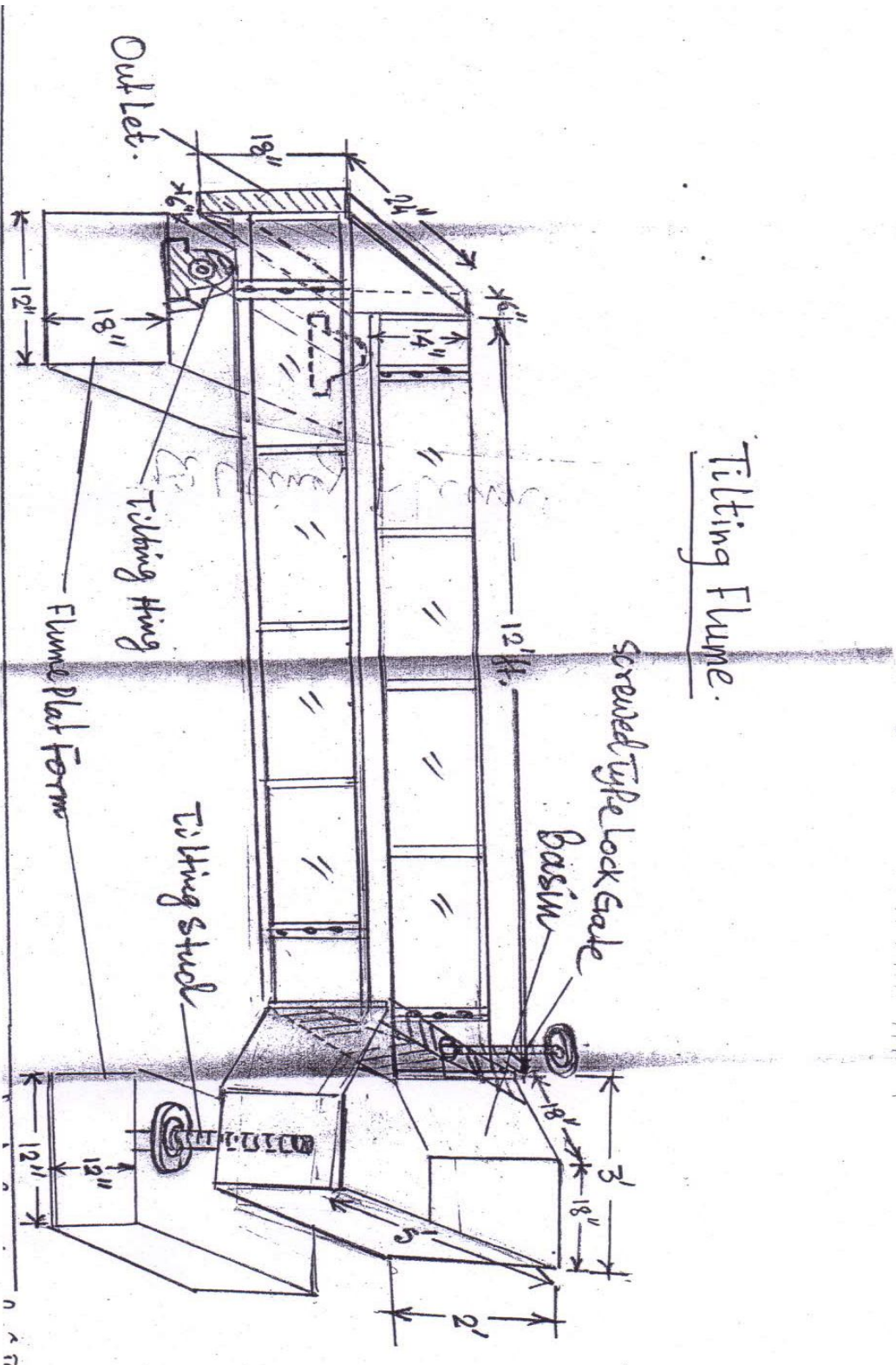

Tilting Flume.